

3-1 Instant Hot Water Tap

USER MANUAL

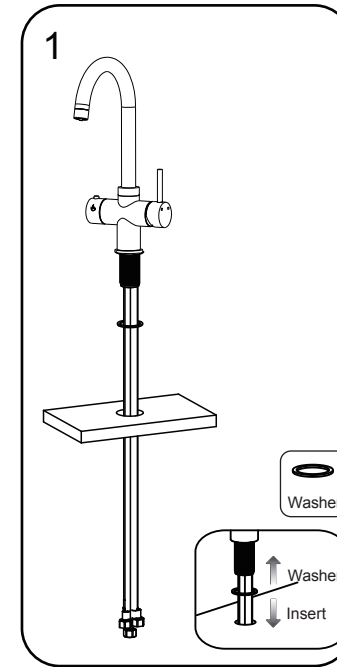

1. Insert the rubber washer (B) over the hoses into faucet shank, and mount the faucet on the basin. See Fig.1

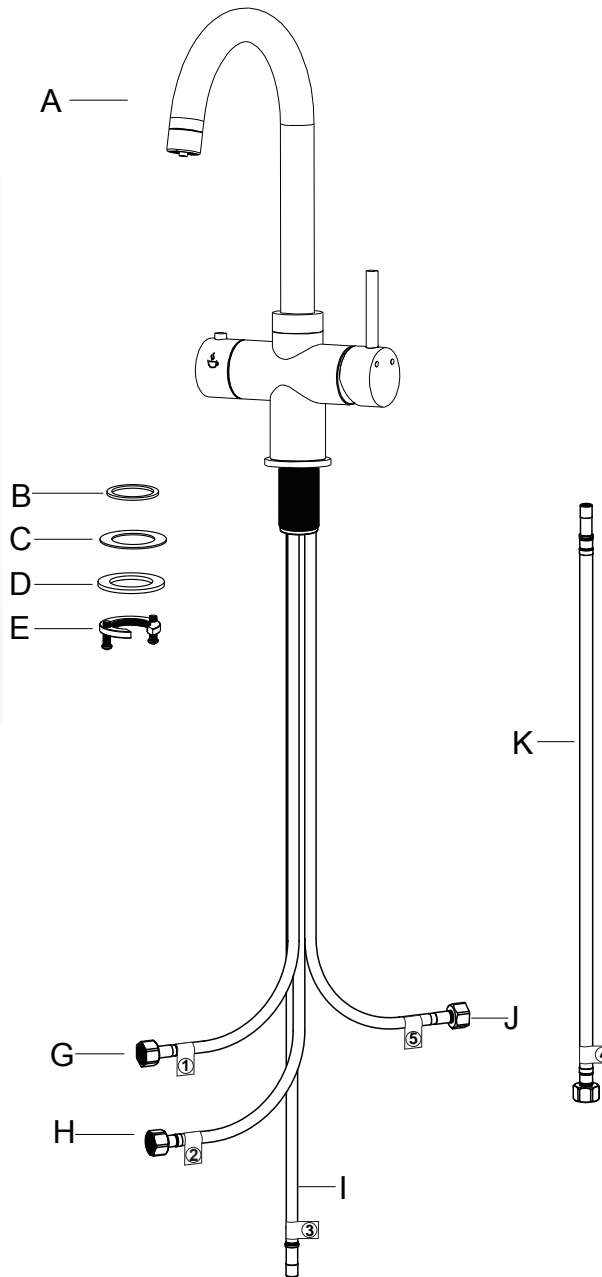
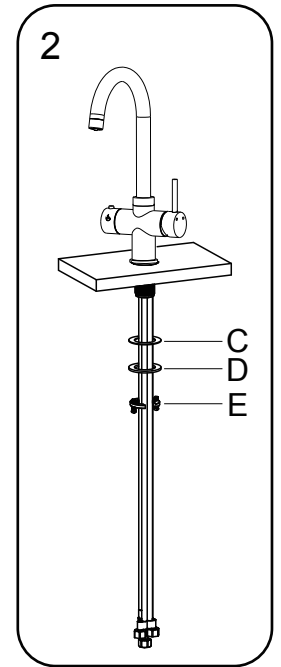

2. Slide the rubber gasket (C) firstly, metal washer (D) secondly, then the mounting nut (E) over the hoses onto the stem, and hand tighten them firmly. See Fig.2

Please note: Pass the 4 hoses with nuts FIRST and then pass 1 tubes without nuts to facilitate installation.

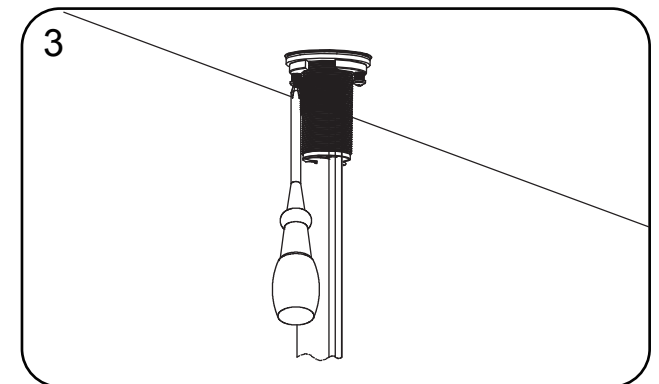

3. Use a Pgillips head screwdriver to thread the 2 screws. See Fig.3

NO.	Description	QTY
A	Faucet	1
B	Rubber Washer	1
C	Rubber Gasket	1
D	Metal Washer	1
E	Mounting Nut	1
G	Cold water Supply Hose	1
H	Hot Water Supply Hose	1
I	Drinking water Inlet hose	1
J	Boiling water outlet hose	1
K	Drinking Water Outlet Hose	1

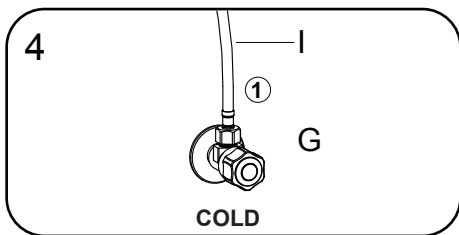
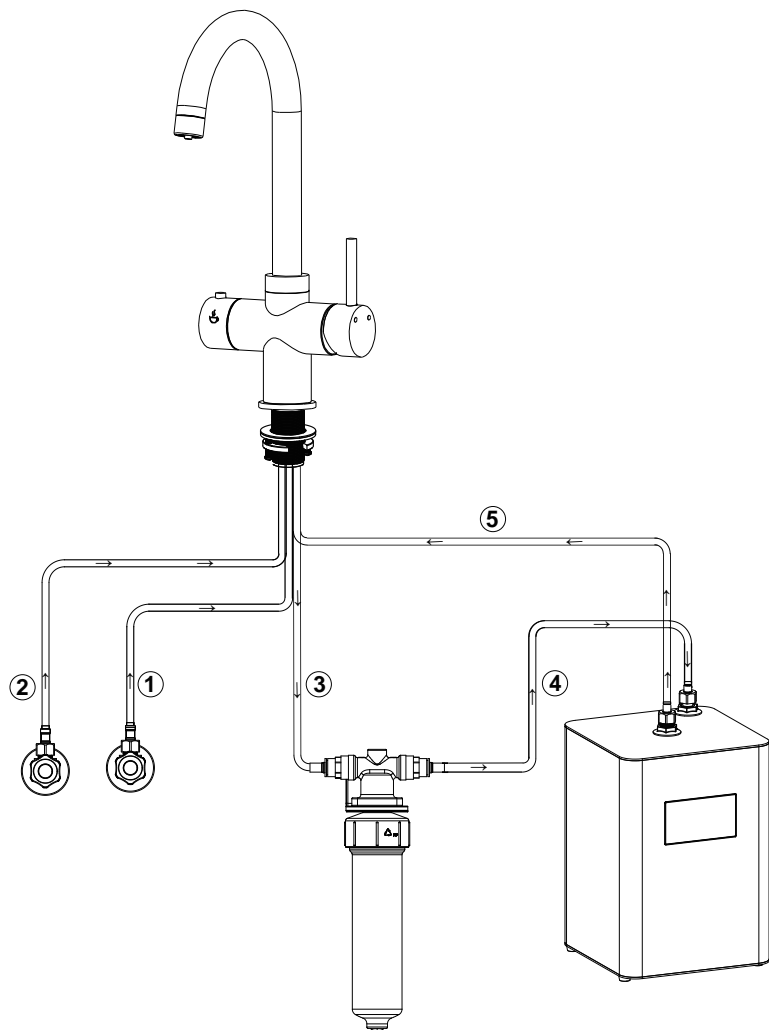

4. Connect the cold supply hose (G) (with label ①) onto the cold Angle Valve. Secure the connection with an adjustable wrench. See Fig.4

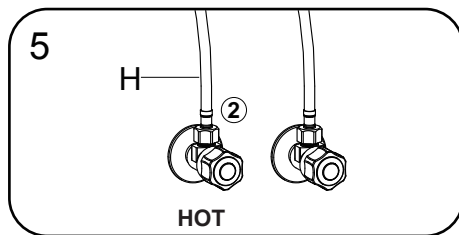

5. Connect the Hot supply hose (H) (with label ②) onto the matching Hot water valves and secure the connection with an adjustable wrench. See Fig.5

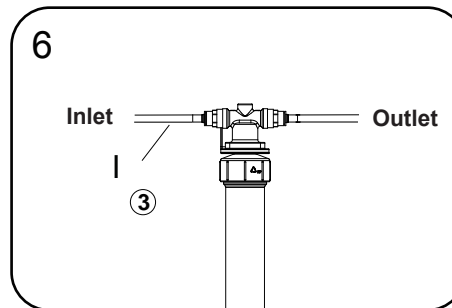

6. Connect the Drinking water Inlet hose(I) with label ③ into the filter housing inlet. See Fig.6

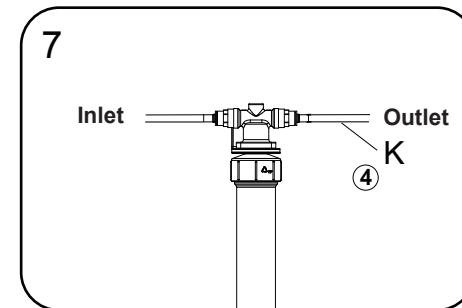

7. Connect the Drinking water Outlet hose(K) with label ④ into the filter housing outlet. See Fig.7

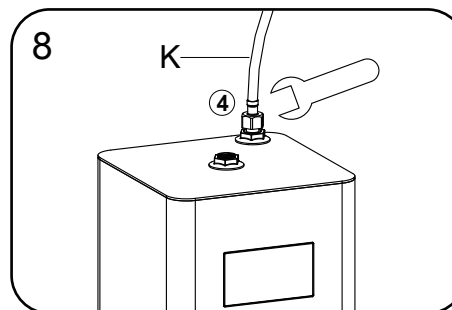

8. Connect the Drinking water Outlet hose(K) with label ④ into the Tank Inlet (Blue Nut). See Fig.8

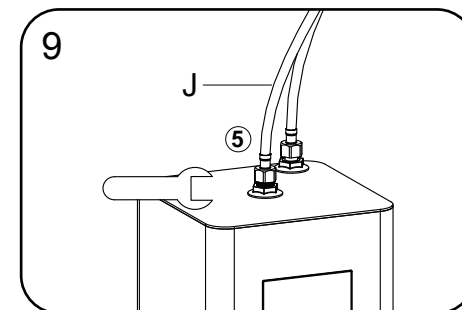

9. Connect the Boiling water outlet hose (J) with label ⑤ into the Tank outlet (Red Nut). See Fig.9

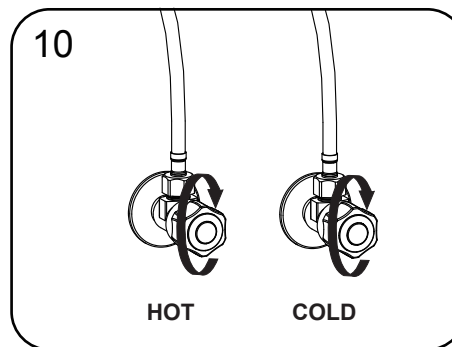

10. Turn on the water supply and check the water connections for leaks. Test systems for leaks, and purge system. Run a minimum of 10 litres of water through the tank to remove any air.

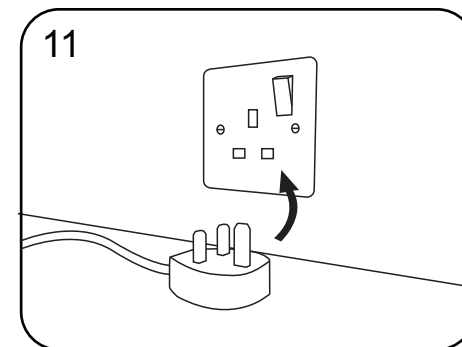

11. Then the installation is completed. Hang the plastic aerator wrench (M) on one of the hoses for future use. Plug tank into electrical outlet and switch unit on, power indicator will flash.